



CHAMFERED WEARSTRIP



CHAMFERED STARTER STRIP



SQUARE FILLER STRIP



SQUARE STARTER STRIP

Wastewater: Wear Strips

Slideways wastewater wear strips are made from reprocessed UHMW and use 1-3/8" washers.

Wastewater Filler Wear Strips

Part No.	Thickness	Width	Length	Centerline
SFWS05	3/8"	2-5/8"	120"	1-5/16"
SFWS10	3/8"	3"	120"	1-1/2"
SFWS15	1/2"	2-1/2"	120"	1-1/4"
SFWS20	1/2"	3"	120"	1-1/2"
SFWS22	1/2"	3-1/2"	120"	1-3/4"
SFWS25	1/2"	4"	120"	2"
SFWS30	1/2"	5"	120"	2-1/2"
SFWS35	5/8"	2-1/2"	120"	1-1/4"
SFWS40	5/8"	3"	120"	1-1/2"
SFWS45	5/8"	4"	120"	2"
SFWS50	5/8"	5"	120"	2-1/2"

Wastewater Starter Wear Strips

Part No.	Thickness	Width	Length	Centerline
SSWS05	3/8"	2-5/8"	120"	1-5/16"
SSWS10	3/8"	3"	120"	1-1/2"
SSWS15	1/2"	2-1/2"	120"	1-1/4"
SSWS20	1/2"	3"	120"	1-1/2"
SSWS22	1/2"	3-1/2"	120"	1-3/4"
SSWS25	1/2"	4"	120"	2"
SSWS30	1/2"	5"	120"	2-1/2"
SSWS35	5/8"	2-1/2"	120"	1-1/4"
SSWS40	5/8"	3"	120"	1-1/2"
SSWS45	5/8"	4"	120"	2"
SSWS50	5/8"	5"	120"	2-1/2"

Washers (sold in boxes of 100)

Part No.	Material	Diameter
SCSW	Carbon steel	1-3/8"
SSWS	Stainless steel	1-3/8"

Wastewater: Wearshoes

Carrying Wearshoe

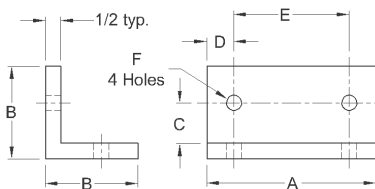

Part Number	A	B	C	D	E	F
SCWS 0001	5-1/2"	3"	1-5/16"	7/8"	3-3/4"	1/2"
SCWS 0550	5-1/2"	3"	1-3/8"	7/8"	3-3/4"	1/2"
SCWS 0600	6"	3"	1-3/8"	1-1/8"	3-3/4"	1/2"

Single-hole Return Wearshoe

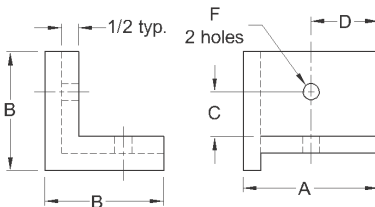

Part Number	A	B	C	D	E	F
SSHRW 001	4"	3-1/2"	1-5/16"	2"	—	1/2"
SSHRW 002	4"	3-1/2"	1-3/8"	2"	—	1/2"
SSHRW 003	4-1/2"	3-1/2"	1-3/8"	2-1/4"	—	1/2"

Double-hole Return Wearshoe

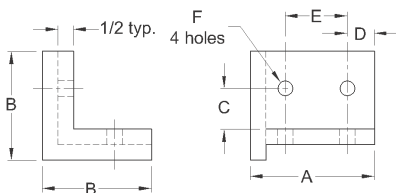

Part Number	A	B	C	D	E	F
SDHRW 0040	4"	3-1/2"	1-3/8"	7/8"	2"	1/2"
SDHRW 0450	4-1/2"	3-1/2"	1-3/8"	7/8"	1"	1/2"
SDHRW 0600	6"	3-1/2"	1-3/8"	1-1/8"	3-3/4"	1/2"

Wastewater: Drag/Pintel Chain for Heavy-Duty Applications

Slideways Drag/Pintel chain is manufactured from reinforced nylon and features stainless steel pins. Drag/Pintel chain is designed for heavier duty applications and has the same advantages as standard plastic roller chain in harsh environments. Wastewater treatment is a common application for this chain.

Drag/Pintel chain is available in 16-D, 23-D, 26-D and NH78. Attachments are available for 23-D, 26-D, and NH78.

Heavy-Duty Drag/Pintel Chain

XX 07 Black Nylon
XX 08 Natural Nylon

Chain Number	Pitch	Overall Width A	Max Spkt Face B	Side Bar Height C	Bushing Length D	Bushing Dia E	Pin Dia F	Weight Lb/Ft	Working Load Lb	Ext Pin Dia/In	Attachments Avail
EC-16D-XX	1.630	2.25	0.62	0.85	1.37	.62	.31	0.64	920	5/16, 3/8, 1/2, 9/16	None
EC-23D-XX	2.308	2.37	0.69	1.00	1.39	.81	.37	0.76	1100	3/8, 7/16	M43
EC-26D-XX	2.609	2.94	0.87	0.94	1.44	.87	.37	1.18	1740	7/16, 1/2, 9/16	F2, K1
EC-NH78-XX	2.609	2.97	1.09	1.14	1.65	.87	.37	1.25	1740	7/16, 1/2, 9/16	F2, K2

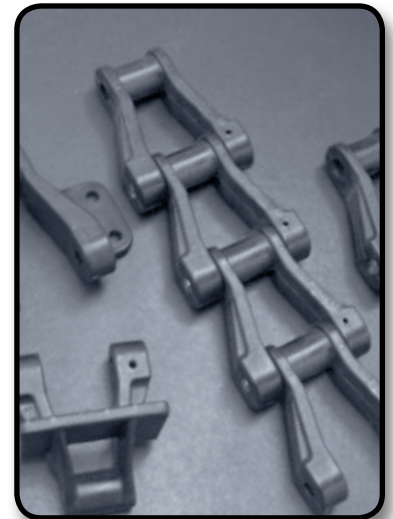

Check Weighers: Plastic Roller Chain for Light-Duty Applications

Plastic chains have been developed for light-duty power transmission applications. They can be used with steel or plastic sprockets, and perform in a wide variety of speeds.

A real advantage of plastic roller chain is that it can perform in harsh chemicals, moisture, and various temperature applications. They self-lubricate and are ideal for applications where cleanliness is important. Food processing, medical and computer equipment and clean rooms are common uses for plastic roller chain.

Plastic roller chain is available in 1/4" pitch, 3/8" pitch and 1/2" pitch in your choice of Nylatron GS, Acetal, Polypropylene and Kynar PVDF.

Light-Duty Plastic Roller Chain

XX 05 Acetal
XX 08 Nylatron GS
XX 19 Polypropylene
XX KY Kynar PVDF

	Pitch	W	D	C	F	L	H
LDC-25-XX	1/4	1/8	.130	.105	.040	.349	.25
LDC-35-XX	3/8	3/16	.20	.141	.075	.545	.35
LDC-40-XX	1/2	5/16	.312	.156	.088	.725	.46

